

**COALBROOK**

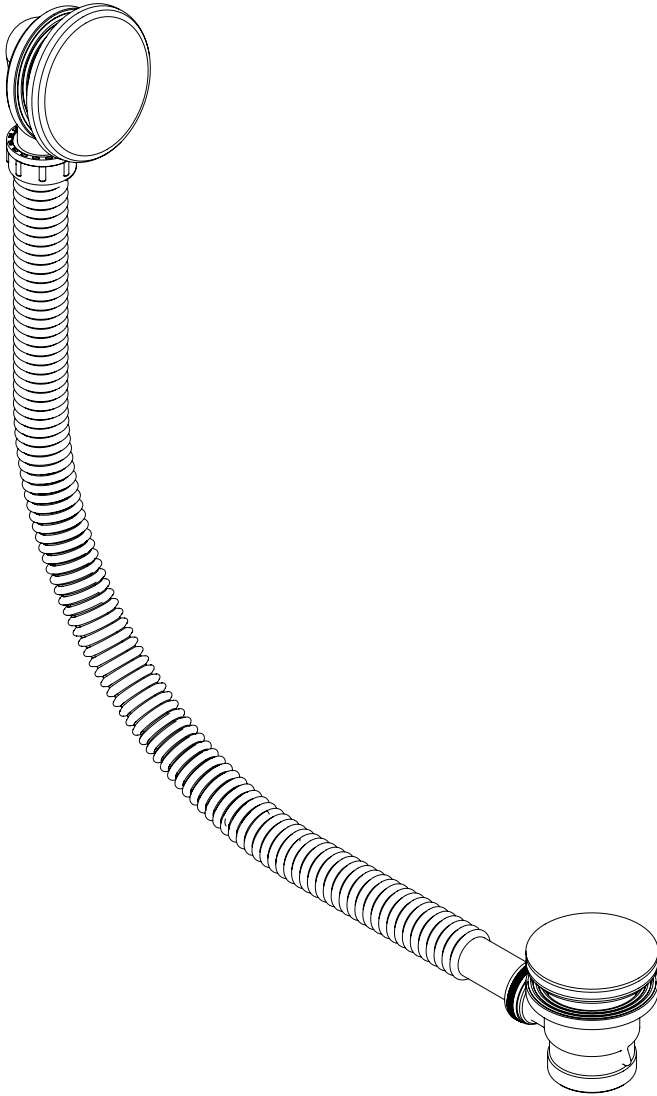

**BATH OVERFLOW**

---

CO5001

## BATH OVERFLOW INSTALLATION DIAGRAM

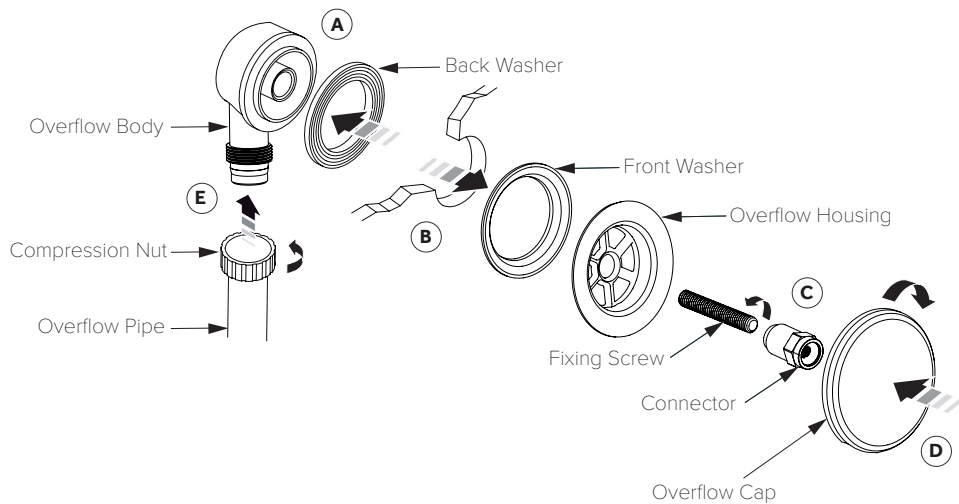

**COALBROOK**

[www.coalbrookuk.co.uk](http://www.coalbrookuk.co.uk) | [info@coalbrookuk.co.uk](mailto:info@coalbrookuk.co.uk)

## BATH OVERFLOW INSTALLATION INSTRUCTIONS

1. The overflow hole in the bath must be between  $\text{Ø}50$  -  $\text{Ø}55$ . Locate the back washer onto the recess on the front face of the overflow body (A) and locate the assembly to the bath overflow hole and hold in place (B).
2. Locate the front washer onto the rear side of the overflow housing.
3. Use the fixing screw to secure the overflow housing into the overflow body (C).
4. Screw the overflow connector into the exposed thread of the fixing screw.
5. Finally, screw the overflow cap to the overflow connector (D).
6. Slide the compression nut over the overflow pipe, push the pipe fully into the overflow assembly and screw on the compression nut (E), hand tighten only.

**COALBROOK**

[www.coalbrookuk.co.uk](http://www.coalbrookuk.co.uk) | [info@coalbrookuk.co.uk](mailto:info@coalbrookuk.co.uk)

# WASTE INSTALLATION DIAGRAM

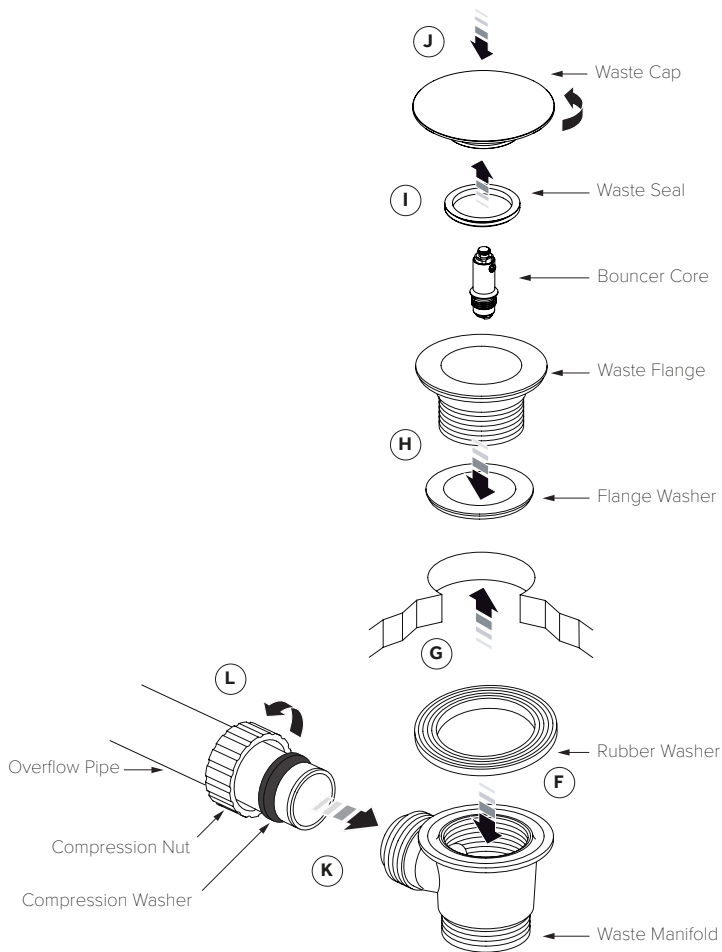

**COALBROOK**

[www.coalbrookuk.co.uk](http://www.coalbrookuk.co.uk) | [info@coalbrookuk.co.uk](mailto:info@coalbrookuk.co.uk)

## WASTE INSTALLATION INSTRUCTIONS

1. Locate the rubber washer into the recess on the waste manifold (F).
2. The hole in the bath needs to be between  $\text{Ø}50$  -  $\text{Ø}55$ . From below push the waste assembly up under the hole in the bath, and hold in place (G).
3. Locate the flange washer over the threaded tail of the waste flange.
4. Screw the waste flange into the waste manifold and tighten by hand (H) (do not over tighten as this may damage the parts and/or the bath).
5. Install the bouncer core.
6. Ensure that the waste seal is fitted to the groove in the waste cap (I).
7. Screw on the waste cap (J).
8. Slide the compression nut and washer over the overflow pipe (K), push the pipe fully into the waste manifold, slide along the compression washer and finally screw on the nut, hand tighten only (L).

**COALBROOK**

[www.coalbrookuk.co.uk](http://www.coalbrookuk.co.uk) | [info@coalbrookuk.co.uk](mailto:info@coalbrookuk.co.uk)

**BATH OVERFLOW SPECIFICATION DIAGRAM (mm)**

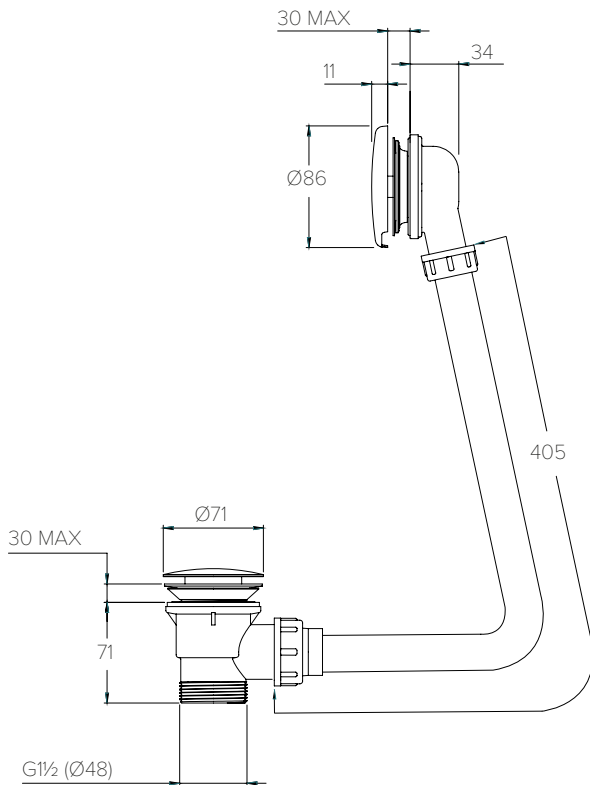

**COALBROOK**

[www.coalbrookuk.co.uk](http://www.coalbrookuk.co.uk) | [info@coalbrookuk.co.uk](mailto:info@coalbrookuk.co.uk)

**COALBROOK**

[www.coalbrookuk.co.uk](http://www.coalbrookuk.co.uk) | [info@coalbrookuk.co.uk](mailto:info@coalbrookuk.co.uk)



**COALBROOK**

Whilst every effort is made to ensure the accuracy of these, they are subject to change without notice as part of the company's product development process. The use of trademarks, product design and artwork is subject to licence or agreement. The design registrations, trademark registrations and copyrights are protected by law and the use or reproduction outside the terms of an agreement is prohibited.

The right to modify designs and dimensions is reserved. E & O.E.

**COALBROOK**

[www.coalbrookuk.co.uk](http://www.coalbrookuk.co.uk) | [info@coalbrookuk.co.uk](mailto:info@coalbrookuk.co.uk)