

**COALBROOK**

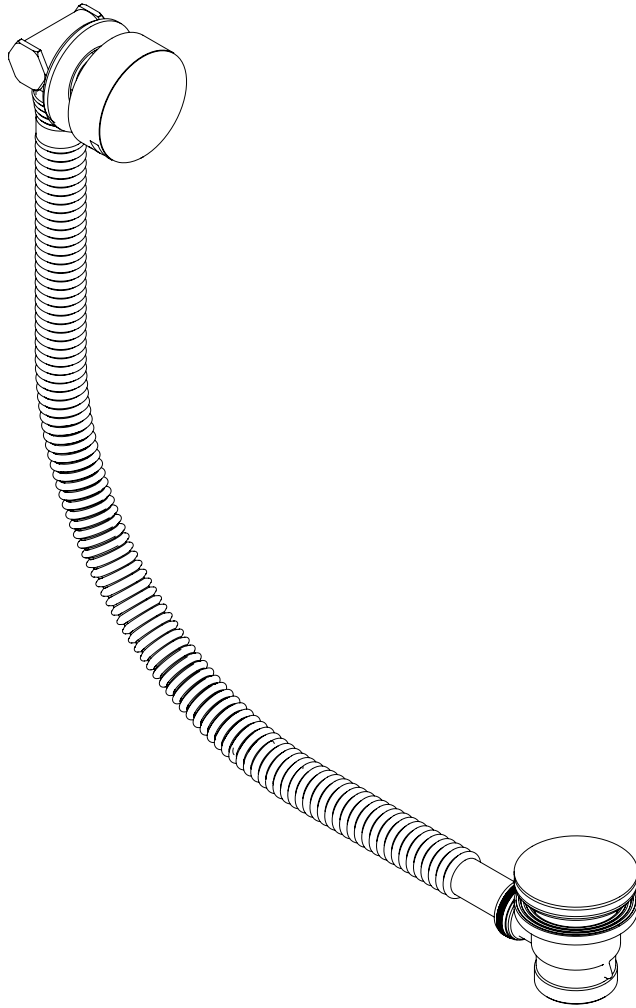

**BATH OVERFLOW FILLER**

---

CO5000

# BATH OVERFLOW FILLER INSTALLATION DIAGRAM

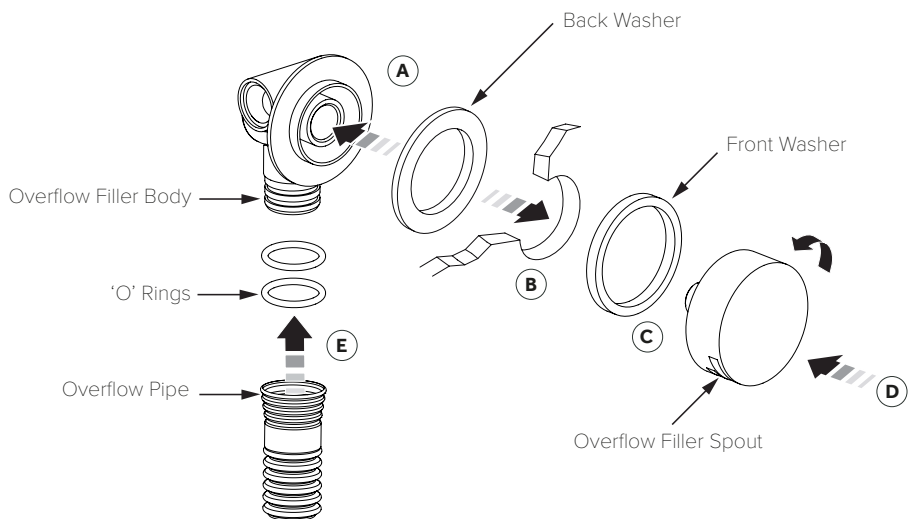

**COALBROOK**

[www.coalbrookuk.co.uk](http://www.coalbrookuk.co.uk) | [info@coalbrookuk.co.uk](mailto:info@coalbrookuk.co.uk)

## BATH OVERFLOW FILLER INSTALLATION INSTRUCTIONS

1. Locate the back washer onto the recess present on the front face of the overflow filler body (A).
2. The overflow hole in the bath needs to be between  $\varnothing 42$  -  $\varnothing 55$ . Push the overflow filler body through the overflow hole in the bath, and hold in place (B).
3. Locate the front washer into the seat on the rear of the overflow filler spout (C).
4. Screw the overflow filler spout into the filler body and tighten by hand, make sure that the slots for filling and the overflow are on the underside (D). Do not over tighten.
5. Remove the blanking plugs from the overflow filler body inlets to expose the connections.
6. Suitable non-restrictive double check valves should be fitted in line with current water regulations.
7. Ensuring that the two 'O' Rings are on the tail of the overflow filler, add a suitable sealant to the outside of the overflow filler tail and locate the overflow pipe onto it (E).
8. Check all connections for leaks before concealing pipework and finishing installation.

**COALBROOK**

[www.coalbrookuk.co.uk](http://www.coalbrookuk.co.uk) | [info@coalbrookuk.co.uk](mailto:info@coalbrookuk.co.uk)

# BATH OVERFLOW FILLER INSTALLATION DIAGRAM

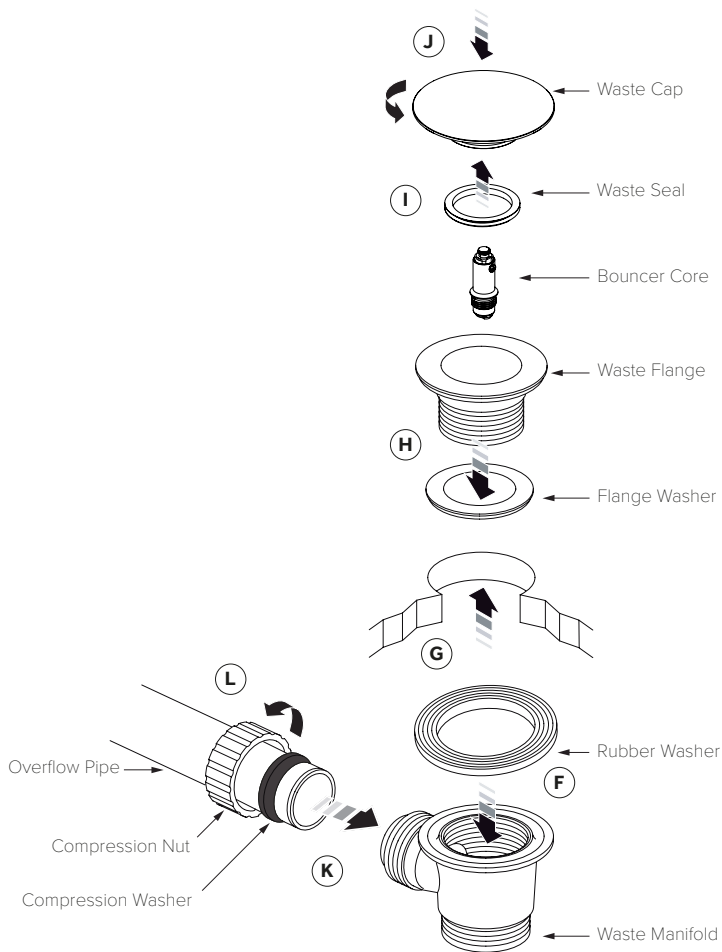

**COALBROOK**

[www.coalbrookuk.co.uk](http://www.coalbrookuk.co.uk) | [info@coalbrookuk.co.uk](mailto:info@coalbrookuk.co.uk)

## BATH OVERFLOW FILLER INSTALLATION INSTRUCTIONS

1. Locate the rubber washer into the recess on the waste manifold (F).
2. The hole in the bath needs to be between  $\text{Ø}50$  -  $\text{Ø}55$ . From below, push the waste assembly up under the hole in the bath and hold in place (G).
3. Locate the flange washer over the threaded tail of the waste flange.
4. Screw the waste flange into the waste manifold and tighten by hand (H). Do not over tighten as this may damage the parts and/or the bath.
5. Ensure that the waste seal is fitted to the groove in the waste cap (I).
6. Screw on the waste cap (J).
7. Slide the compression nut and washer over the overflow pipe (K), push the pipe fully into the waste manifold, slide along the compression washer and finally screw on the nut, hand tighten only (L).

**COALBROOK**

[www.coalbrookuk.co.uk](http://www.coalbrookuk.co.uk) | [info@coalbrookuk.co.uk](mailto:info@coalbrookuk.co.uk)

**SPECIFICATION DIAGRAM (mm)**

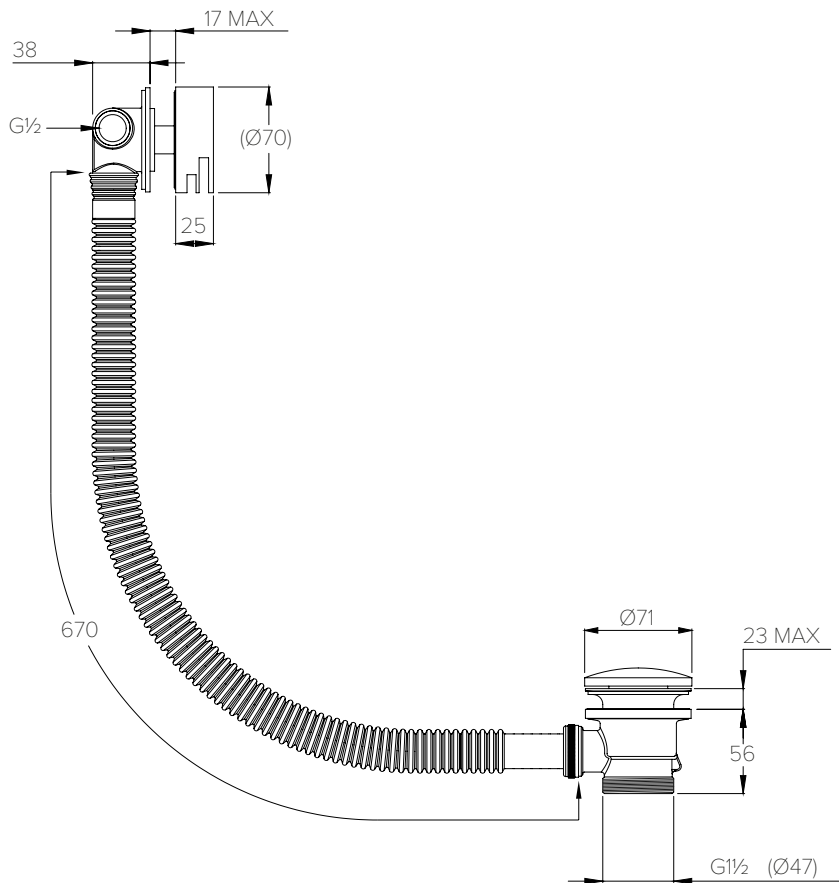

**COALBROOK**

[www.coalbrookuk.co.uk](http://www.coalbrookuk.co.uk) | [info@coalbrookuk.co.uk](mailto:info@coalbrookuk.co.uk)

**COALBROOK**

[www.coalbrookuk.co.uk](http://www.coalbrookuk.co.uk) | [info@coalbrookuk.co.uk](mailto:info@coalbrookuk.co.uk)



**COALBROOK**

Whilst every effort is made to ensure the accuracy of these, they are subject to change without notice as part of the company's product development process. The use of trademarks, product design and artwork is subject to licence or agreement. The design registrations, trademark registrations and copyrights are protected by law and the use or reproduction outside the terms of an agreement is prohibited.

The right to modify designs and dimensions is reserved. E & O.E.

**COALBROOK**

[www.coalbrookuk.co.uk](http://www.coalbrookuk.co.uk) | [info@coalbrookuk.co.uk](mailto:info@coalbrookuk.co.uk)