

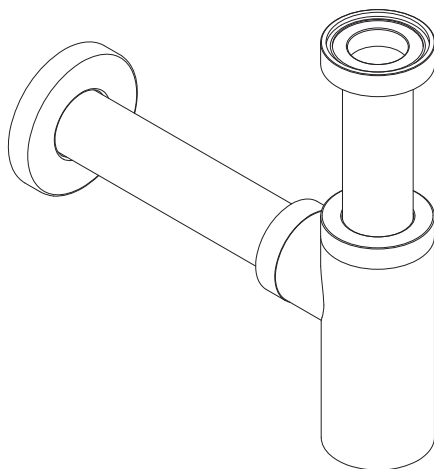

COALBROOK



BASIN BOTTLE TRAP INSTALLATION

IMPORTANT INFORMATION

Professional installation

We recommend that Coalbrook product are fitted by a fully qualified professional plumber. It should be installed correctly and in accordance with all local water regulations. All products should be accessible for routine servicing.

COALBROOK

www.coalbrookuk.co.uk | info@coalbrookuk.co.uk

BOTTLE TRAP INSTALLATION (STEPS 1-5)

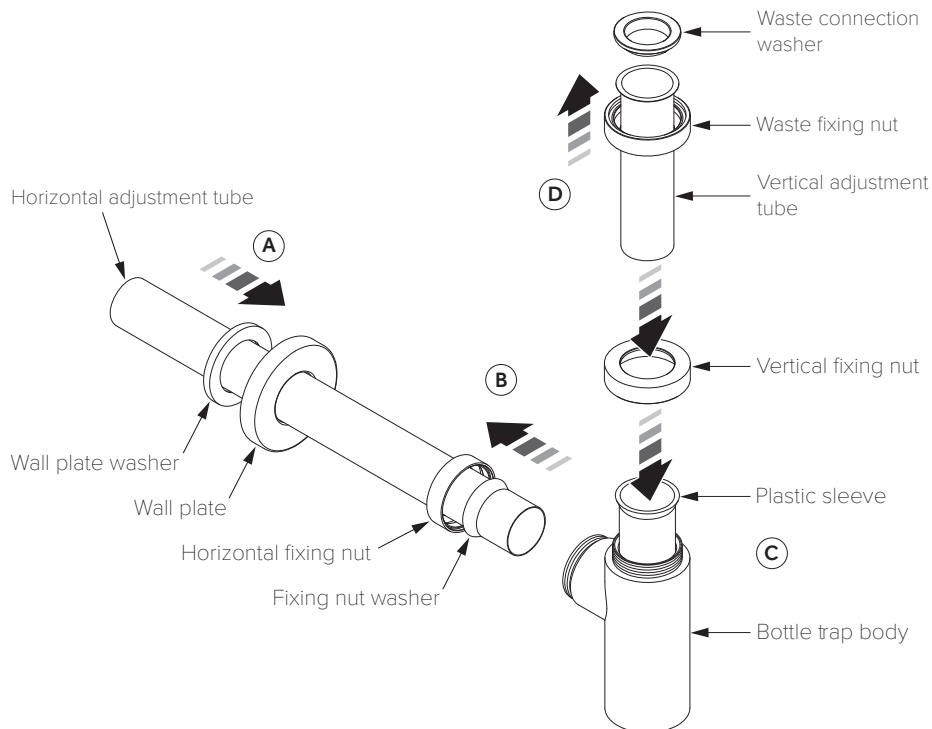

1. The horizontal adjustment tube must be cut to the required length.
2. The bottle trap requires assembly. On the horizontal axis, slide the wall plate and its washer onto the horizontal tube as shown (A). Slide the horizontal fixing nut and its washer onto the horizontal tube as shown (B).
3. On the vertical axis, fully insert the plastic sleeve into the bottle trap body (C). Locate and screw the vertical fixing nut onto the top of the bottle trap body. Do not tighten at this stage.
4. On the vertical axis, slide the waste fixing nut along the vertical adjustment tube with the thread facing upward (D). Locate the vertical adjustment tube assembly into the top of the bottle trap body.
5. Locate the waste connection washer on the flange at the top of the vertical adjustment tube.

COALBROOK

www.coalbrookuk.co.uk | info@coalbrookuk.co.uk

BOTTLE TRAP INSTALLATION (STEPS 6-10)

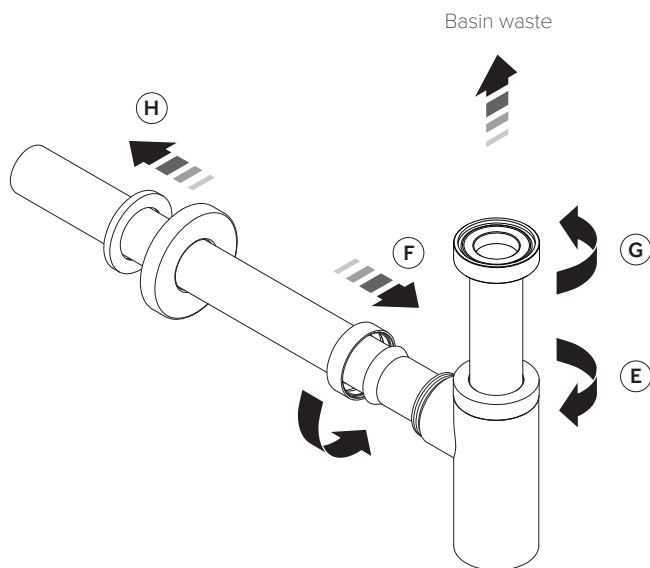

6. Set the vertical adjustment tube to the required height. Secure by tightening the vertical fixing nut (E).
7. Insert the horizontal tube into the bottle trap body and secure by tightening the fixing nut onto the bottle trap body (F).
8. Ensure that the waste connection washer is still in place. Connect the vertical section of the bottle trap to the basin waste using the waste fixing nut (G).
9. Connect the horizontal adjustment tube to the waste outlet. Check for leaks.
10. Slide the wall plate up to the wall. Use a suitable sealant to secure in place (H).

BOTTLE TRAP SPECIFICATION DIAGRAM (mm)

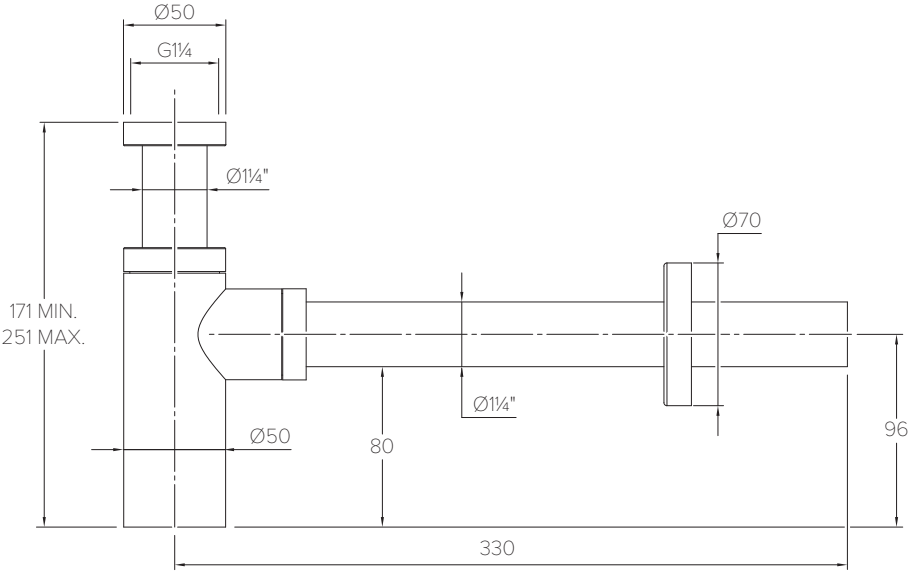



COALBROOK

Whilst every effort is made to ensure the accuracy of these, they are subject to change without notice as part of the company's product development process. The use of trademarks, product design and artwork is subject to licence or agreement. The design registrations, trademark registrations and copyrights are protected by law and the use or reproduction outside the terms of an agreement is prohibited.

The right to modify designs and dimensions is reserved. E & O.E.

V2.0625

COALBROOK

www.coalbrookuk.co.uk | info@coalbrookuk.co.uk