

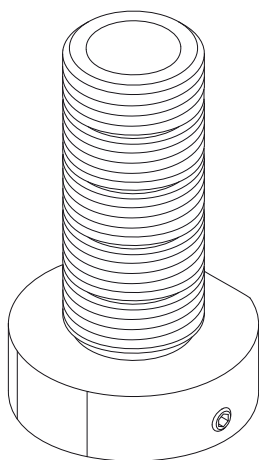

**COALBROOK**



**CONCEALED CEILING BRACKET INSTALLATION**

---



### Installation

We recommend that Coalbrook products are installed by a fully qualified professional plumber. They should be installed correctly and in accordance with all local water regulations. Additionally, all products and connections should be accessible for routine servicing.

### System suitability

This Coalbrook product is potentially suitable for every possible application, type of boiler, and water supply pressure. However, for full 'power' shower performance, it is advisable to fit a water pump if the supply pressure is below 1 bar. For systems with combination boilers, it is not advisable to fit pumps (refer to the boiler manufacturer for guidance).

### Flushing system

It is most important to flush out all pipework thoroughly before connecting the product. Failure to do so is the single most common cause of water restriction.

### Supply temperature safety notice

A thermostatic mixing valve (TMV) should be fitted (not supplied) to the hot supply to restrict the temperature to a safe working/maximum temperature to comply with local building regulations, current legislation, relevant standards and codes of practice. Maximum allowed temperatures vary subject to type of installation or specification of building.

### Duty of care

#### Legislation

Legislation dictates recommendations and guidelines on health and safety, including safe hot water temperatures. The emphasis is on regulatory and design criteria, with responsibility for meeting such guidelines being that of a suitably appointed responsible person.

#### How hot water temperatures affect the skin

- 65°C – A partial thickness burn in about 2 seconds
- 60°C – A partial thickness burn in about 5 seconds
- 55°C – A partial thickness burn in about 15 seconds
- 50°C – A partial thickness burn in about 90 seconds

#### Safe temperature

The age, mental and physical capabilities of persons occupying the property will affect the setting of the hot water supply. For specific details, please refer to local building regulations, current legislation, relevant standards and codes of practice.

## CEILING BRACKET INSTALLATION (STEPS 1-2)

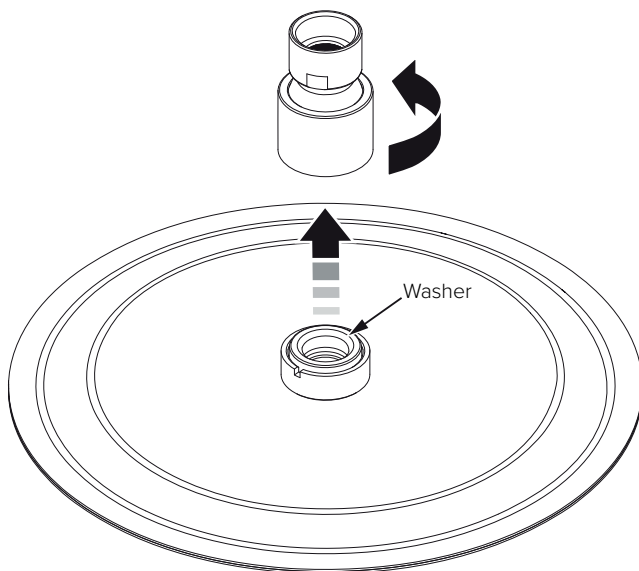

1. Unscrew and remove the swivel adapter from the top of the shower rose. Wearing rubber gloves will aid with grip.
2. There is a washer inside the threaded section on top of the rose. The washer must not be removed.

**COALBROOK**

[www.coalbrookuk.co.uk](http://www.coalbrookuk.co.uk) | [info@coalbrookuk.co.uk](mailto:info@coalbrookuk.co.uk)

## CEILING BRACKET INSTALLATION (STEPS 3-6)

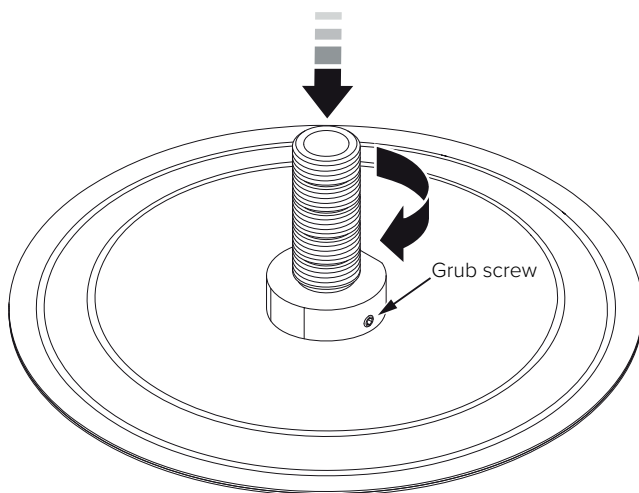

3. If required, the threaded tail of the ceiling bracket can be shortened. Cut locations are present along the threaded tail. Ensure that the threads are not damaged during cutting.
4. Screw the ceiling bracket fully onto the threaded section on top of the shower rose.
5. There is a grub screw located on the side of the ceiling bracket. Tighten the grub screw to secure the assembly.
6. The assembly can be secured using a G1/2 nut where access permits, or it can be screwed into a female G1/2 adapter mounted within the ceiling.

**COALBROOK**

[www.coalbrookuk.co.uk](http://www.coalbrookuk.co.uk) | [info@coalbrookuk.co.uk](mailto:info@coalbrookuk.co.uk)

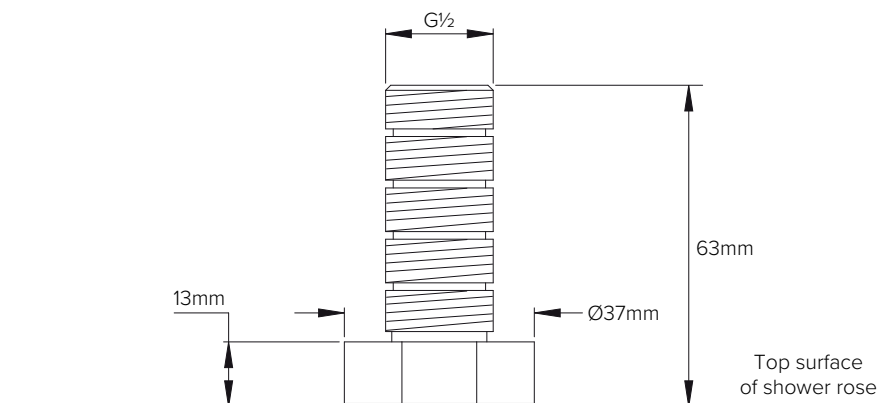





**COALBROOK**

Whilst every effort is made to ensure the accuracy of these, they are subject to change without notice as part of the company's product development process. The use of trademarks, product design and artwork is subject to licence or agreement. The design registrations, trademark registrations and copyrights are protected by law and the use or reproduction outside the terms of an agreement is prohibited.

The right to modify designs and dimensions is reserved. E & O.E.

V2.0825

**COALBROOK**

[www.coalbrookuk.co.uk](http://www.coalbrookuk.co.uk) | [info@coalbrookuk.co.uk](mailto:info@coalbrookuk.co.uk)