

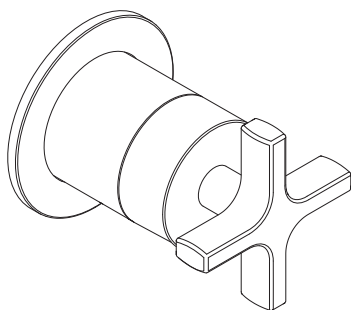

COALBROOK

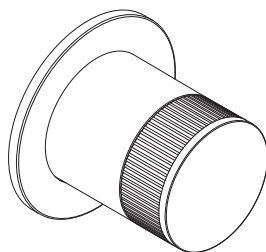
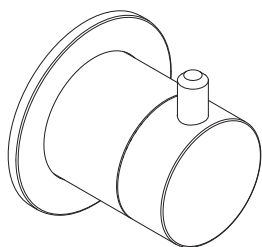

WALL MOUNTED DIVERTER INSTALLATION

Professional installation

We recommend that our products are fitted by a fully qualified professional plumber. They should be installed correctly and in accordance with all local water regulations and the system protected by non-return valves where required (not supplied). All products should be accessible for routine servicing.

Suits all systems

This Coalbrook product is potentially suitable for every possible application, type of boiler and water supply pressure. However, if your supply pressure is below 1 bar it is advisable to fit a water pump. For systems with combination boilers, it is not advisable to fit pumps (refer to boiler manufacturer).

Supply temperature safety notice

A thermostatic mixing valve (TMV) should be fitted (not supplied) to the hot supply to restrict the temperature to a safe working/maximum temperature to comply with local building regulations, current legislation, relevant standards and codes of practice. Maximum allowed temperatures vary subject to type of installation or specification of building.

Flushing system

It is most important to flush out all pipework thoroughly before connecting to the product. Failure to do so is the single most common cause of cartridge failure and water restriction.

Balancing flow

If a significant pressure difference exists between the hot and cold supplies, we advise fitting a 'flow regulator' (not supplied) to the higher or both supplies.

Water quality

In hard water areas, a suitable water treatment system should be provided to prevent limescale deposits (calcium deposits) which may effect the long term performance of the diverter cartridge. Exterior surfaces should be gently wiped with a dry soft cloth after use to minimise water stains and limescale deposits.

SPECIFICATION DIAGRAM (ROUGH) (mm)

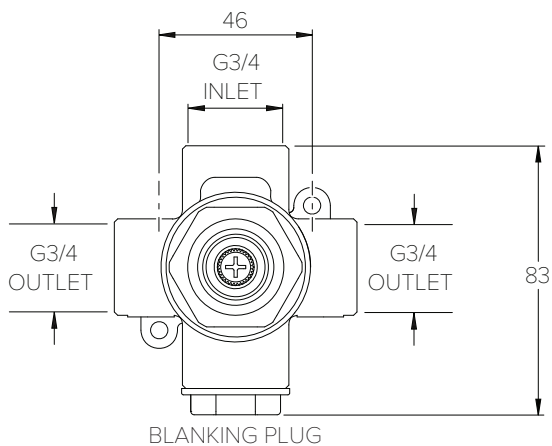
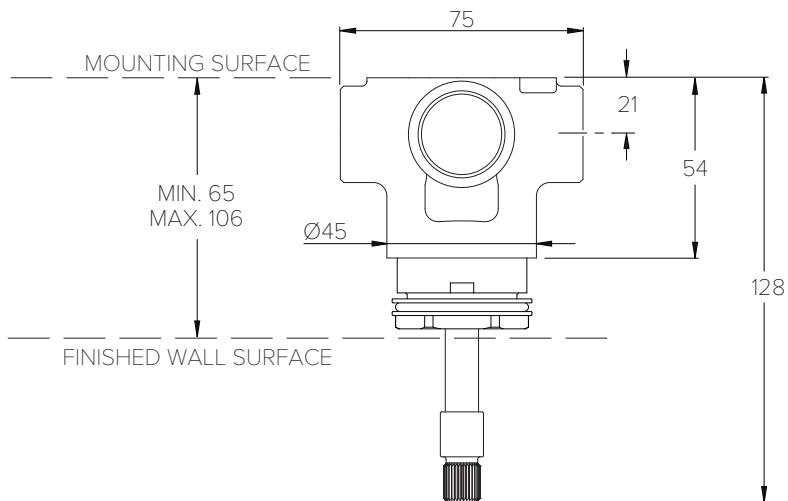

The diverter is supplied with a blanking plug fitted.
This can be removed if an additional supply inlet is required.

COALBROOK

www.coalbrookuk.co.uk | info@coalbrookuk.co.uk

SPECIFICATION DIAGRAM (TRIMS) (mm)

BA2007

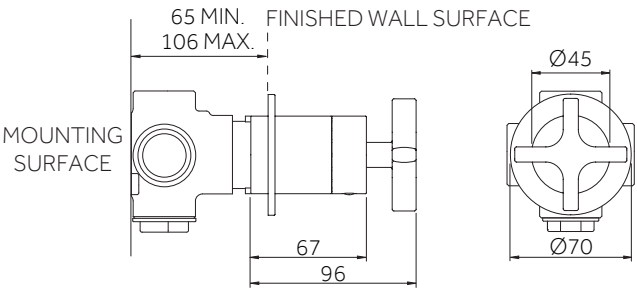

DC2007

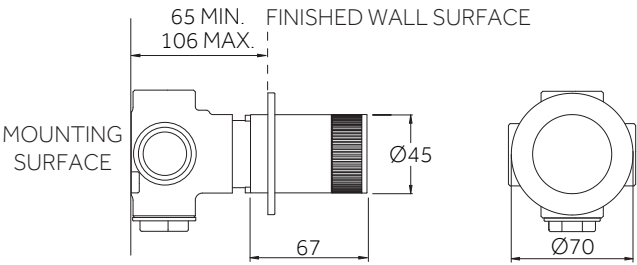

DO2007

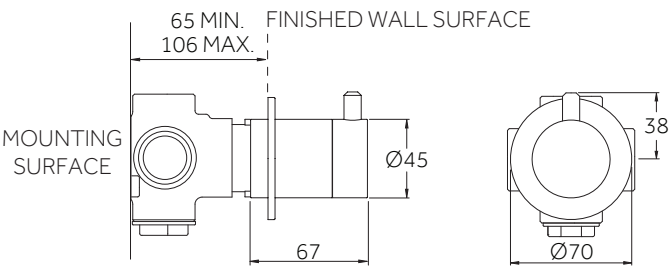

DIVERTER INSTALLATION (STEPS 1 - 3)

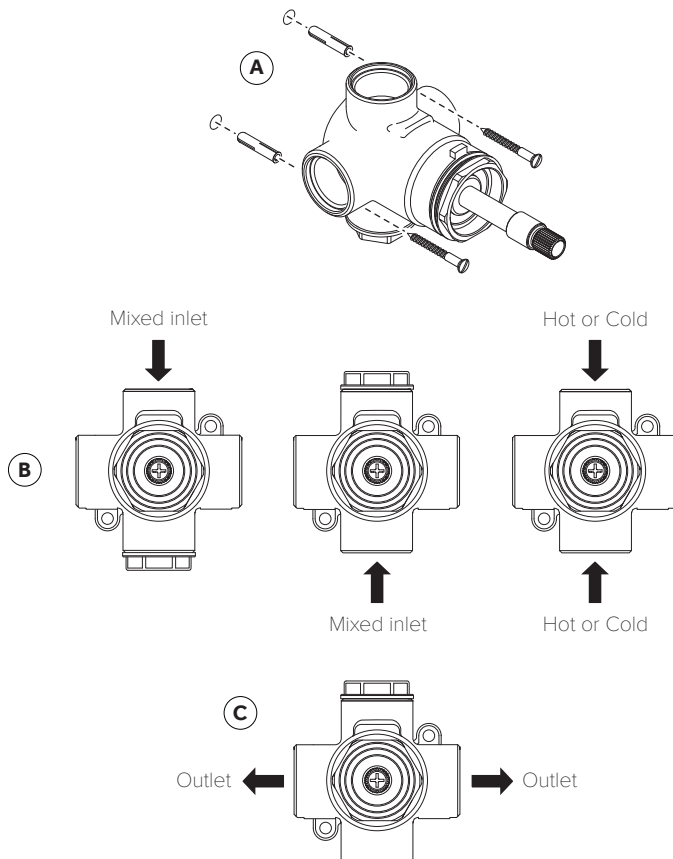

1. Locate and secure the diverter to the mounting surface using suitable fixings (A).
2. Connect the inlets to the diverter. A single mixed inlet can be used, or the blanking plug can be removed to allow hot & cold inlets at the bottom and top (B).
3. Connect the outlets to the diverter. Always check for leaks before applying the finished wall surface. A 48mm - 50mm diameter hole is recommended in the finished wall surface. This will enable the rubber washer in the rear of the wall plate to make contact with the finished wall.

COALBROOK

www.coalbrookuk.co.uk | info@coalbrookuk.co.uk

HANDLE SHROUD & WALL PLATE INSTALLATION (STEPS 4 - 7)

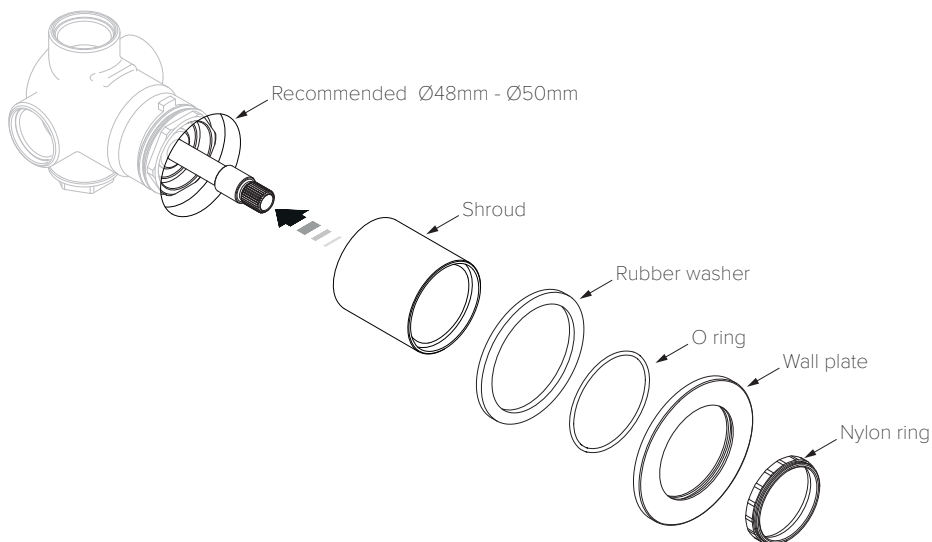

4. Locate and gently push the handle shroud on to the diverter body.
5. Ensure that the central O ring and rear rubber washer are installed into the wall plate.
6. Gently slide the wall plate over the shroud up to the wall surface.
7. Insert the nylon ring into the shroud.

BANK & DOMO TRIM INSTALLATION (STEPS 8 - 9)

BANK

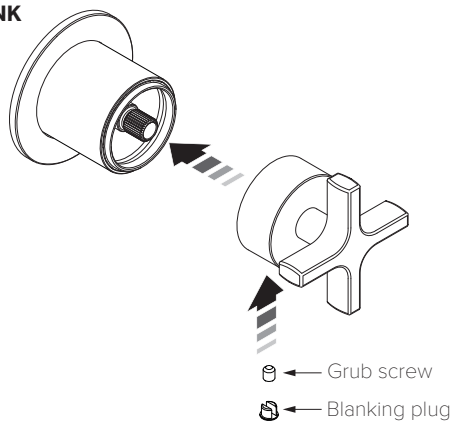

DOMO

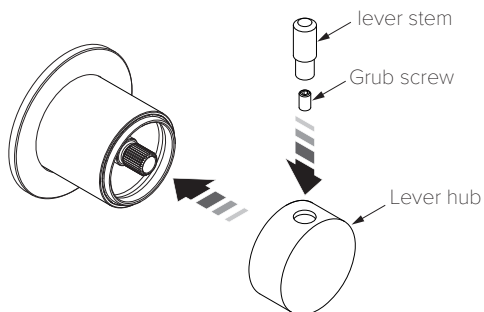

8. For the BANK trim assembly, locate the handle assembly on to the diverter splines and secure using the grub screw provided. Locate and secure the decorative blanking plug with light pressure.
9. For the DOMO trim assembly, locate the lever hub onto the diverter spline and secure using the grub screw provided. Screw the lever stem into the lever hub.

COALBROOK

www.coalbrookuk.co.uk | info@coalbrookuk.co.uk

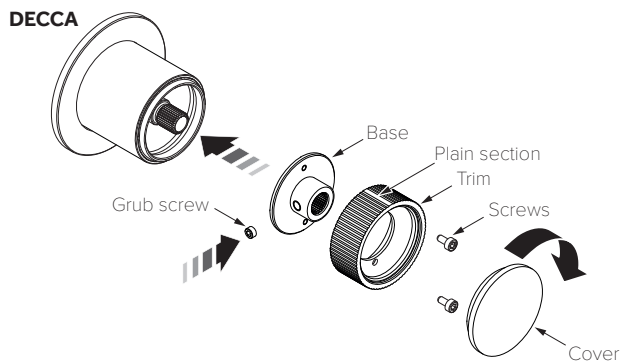

10. For the DECCA trim assembly, rotate the handle base until the two small holes are vertical. Locate the base onto the diverter splines and secure using the grub screw provided.
11. Secure the handle trim to the base using the two set screws provided. The plain section of the flow control handle should be aligned so that it is on top when in the 'OFF' position.
12. Screw the cover onto the trim to complete the installation.

TYPICAL FLOW RATES

Flow rates shown are free-flowing and may vary subject to restrictions created by installation, pipework layout or application

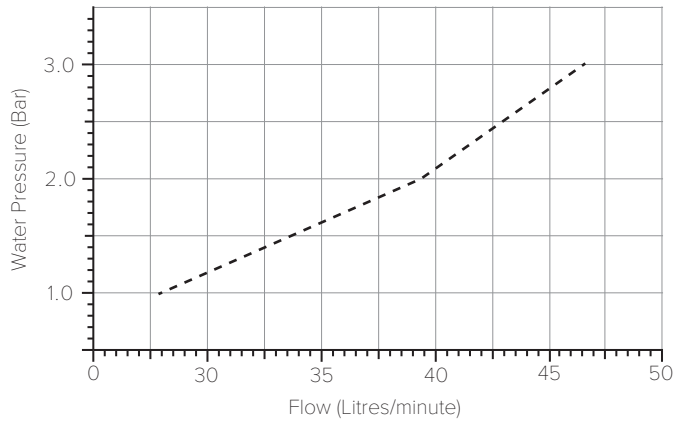

| Water Pressure (Bar) | Outlet (Litres/minute) |
|----------------------|------------------------|
| 1.0 | 27.7 |
| 2.0 | 39.4 |
| 3.0 | 46.6 |



COALBROOK

Whilst every effort is made to ensure the accuracy of these, they are subject to change without notice as part of the company's product development process. The use of trademarks, product design and artwork is subject to licence or agreement. The design registrations, trademark registrations and copyrights are protected by law and the use or reproduction outside the terms of an agreement is prohibited.

The right to modify designs and dimensions is reserved. E & O.E.

V3.0625

COALBROOK

www.coalbrookuk.co.uk | info@coalbrookuk.co.uk