

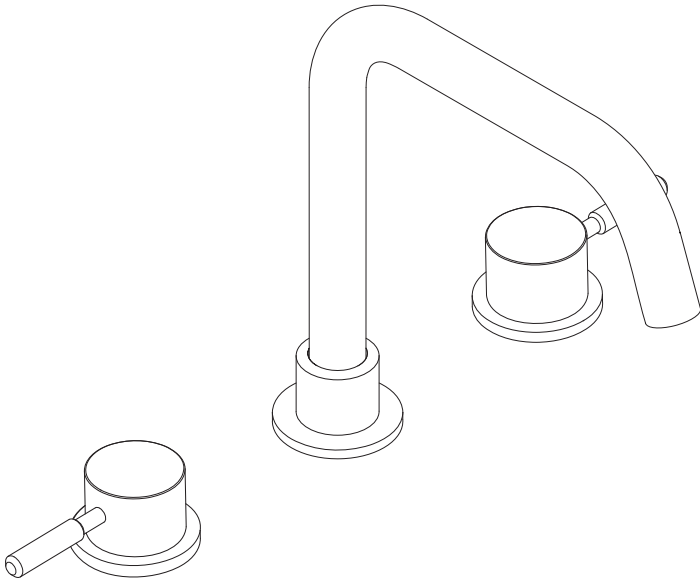

**COALBROOK**



**3 HOLE DECK MOUNTED SWIVEL SPOUT  
BATH FILLER INSTALLATION**



## IMPORTANT INFORMATION

### Professional installation

We recommend that our products are fitted by a fully qualified professional plumber. They should be installed correctly and in accordance with all local water regulations and the system protected by non-return valves (not supplied). All products should be accessible for routine servicing.

### Supply temperature safety notice

A thermostatic mixing valve (TMV) should be fitted (not supplied) to the hot supply to restrict the temperature to a safe working/maximum temperature to comply with local building regulations, current legislation, relevant standards and codes of practice. Maximum allowed temperatures vary subject to type of installation or specification of building.

### Flushing system

It is most important to flush out all pipework thoroughly before connecting the mixer. Failure to do so is the single most common cause of water restriction or cartridge failure.

### Supply connections

The hot water supply must be connected to the bottom inlet port of the left flow valve, and cold water to the bottom inlet port of the right flow valve, as viewed from the front.

### Balancing flow

If a significant pressure difference exists between the hot and cold supplies, we advise fitting a 'flow regulator' (not supplied) to the higher or both supplies.

### Water quality

In hard water areas, a suitable water treatment system should be provided to prevent limescale deposits (calcium deposits) which may reduce the long term performance of the bath filler cartridges. Exterior surfaces should be gently wiped with a dry soft cloth after use to minimise water stains and limescale deposits.

## SPOUT INSTALLATION

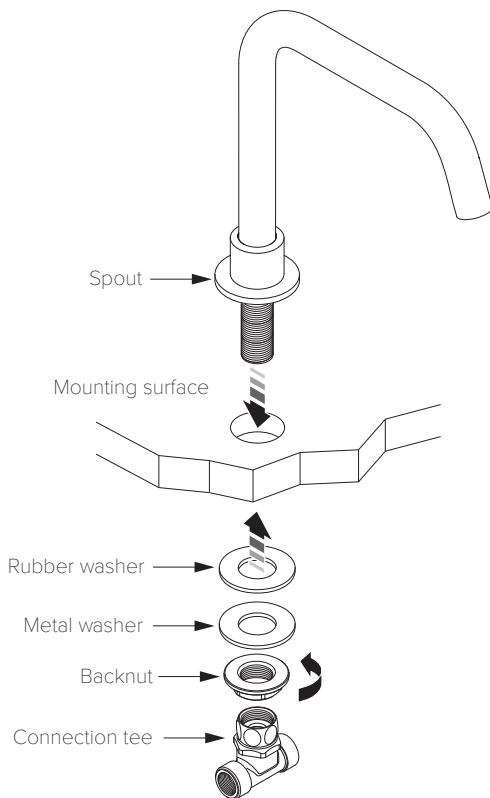

1. When necessary, drill a suitable hole in the mounting surface to suit the  $\text{\O}21\text{mm}$  threaded tail.
2. Pass the threaded tail of the spout through the hole in the mounting surface.
3. Locate both washers onto the threaded tail. Ensure that the rubber washer is assembled first so that it has direct contact with the mounting surface.
4. Screw the backnut onto the threaded tail and tighten to secure the spout. Do not over tighten.
5. Once the spout is secured, the connection tee can be screwed onto the end of the threaded tail.

**COALBROOK**

[www.coalbrookuk.co.uk](http://www.coalbrookuk.co.uk) | [info@coalbrookuk.co.uk](mailto:info@coalbrookuk.co.uk)

## FLOW VALVE INSTALLATION FOR ALL MODELS

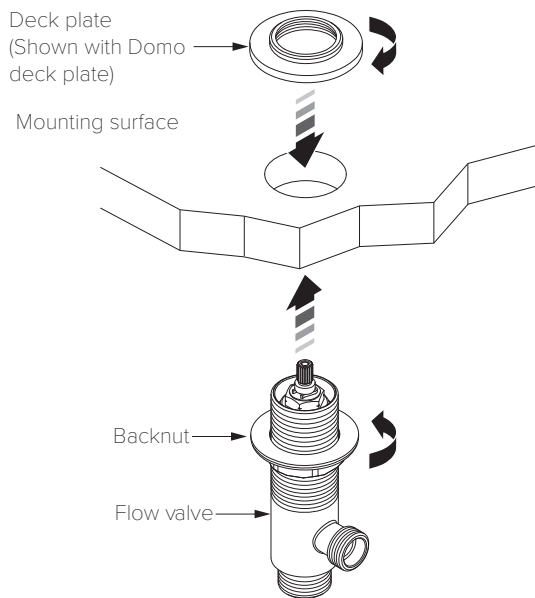

### BANK, DECCA, DOMO & ZURICH

1. When necessary, drill suitable holes in the mounting surface to suit the  $\text{\O}35\text{mm}$  flow valve bodies.
2. Locate a flow valve body through a hole in the mounting surface.
3. Screw the deck plate onto the top of the flow valve until it comes to a natural stop. Bank, Domo & Zurich locate to the top of the flow valve. Decca locate to the top of the ceramic cartridge.
4. Screw the backnut up to the mounting surface to secure.
5. Repeat steps 2 to 4 for the remaining valve.

Note: Suitable access is required underneath the mounting surface. The flow cartridges can only be serviced by removing the side valve assemblies from their mounted position.

**COALBROOK**

[www.coalbrookuk.co.uk](http://www.coalbrookuk.co.uk) | [info@coalbrookuk.co.uk](mailto:info@coalbrookuk.co.uk)

## FLOW VALVE TRIM INSTALLATION FOR DECCA & DOMO MODELS

### DECCA

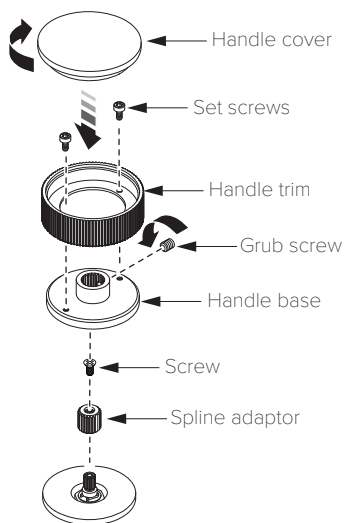

### DOMO

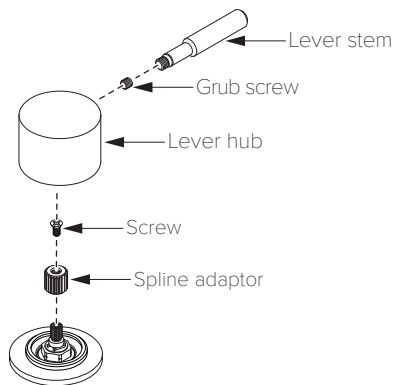

### DECCA

1. Locate the spline adaptors onto the flow valve splines. Secure using the supplied screws.
2. Locate the handle bases onto the spline adaptors and secure using the provided grub screws and a suitable hexagonal key.
3. Locate the handle trims onto the handle bases. Align the holes in both components and secure the handle trims using the set screws provided.
4. Locate and screw the handle covers into the handle trims.

### DOMO

1. Locate the spline adaptors onto the flow valve splines. Secure using the supplied screws.
2. Rotate the lever hubs to the required orientation. Locate the lever hubs onto the spline adaptors. Secure the lever hubs by screwing the grub screws into the lever hubs using a suitable hexagonal key.
3. Locate and screw the lever stems into the lever hubs.

**COALBROOK**

[www.coalbrookuk.co.uk](http://www.coalbrookuk.co.uk) | [info@coalbrookuk.co.uk](mailto:info@coalbrookuk.co.uk)

## FLOW VALVE TRIM INSTALLATION FOR BANK & ZURICH MODELS

### BANK

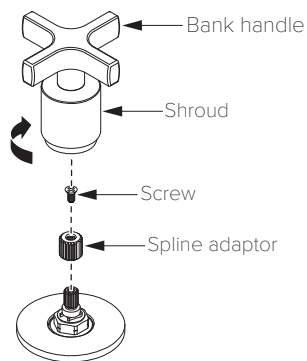

### ZURICH

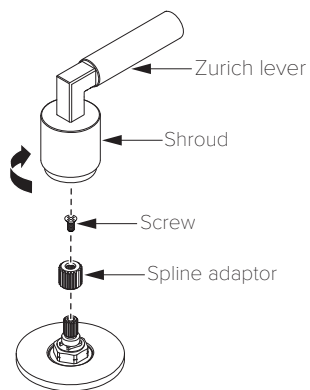

### BANK & ZURICH

1. Locate the spline adaptors onto the flow valve splines. Secure using the supplied screws.
2. Rotate the handles to the required orientation. Offer the handles to the flow valves. Locate the base of the handle shrouds through the centre of the deck plate. Rotate the shrouds to secure. Do not over tighten the shrouds.

**SPECIFICATION DIAGRAM (mm)**

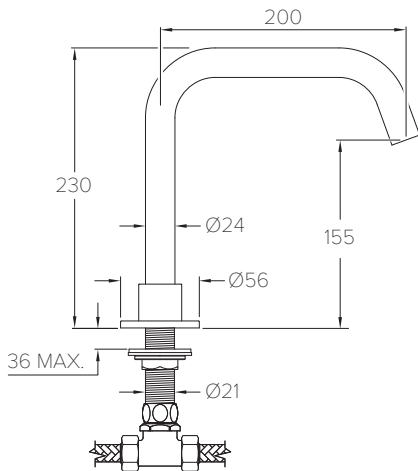

**BANK**

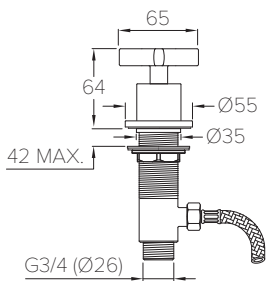

**DECCA**

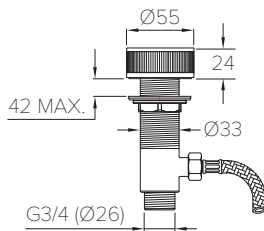

**DOMO**

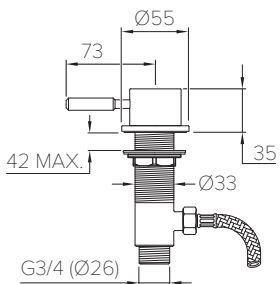

**ZURICH**

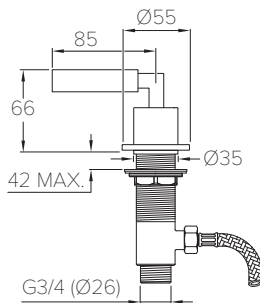

**COALBROOK**



## TYPICAL FLOW RATES

Flow rates shown are free-flowing and may vary subject to restrictions created by installation, pipework layout or application.

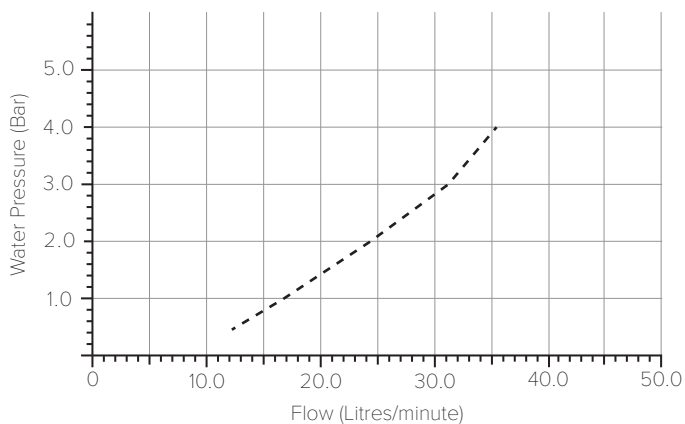

Water Pressure (Bar)	Outlet (Litres/minute)
0.5	12.1
1.0	16.9
2.0	24.4
3.0	31.1
4.0	35.3







**COALBROOK**

Whilst every effort is made to ensure the accuracy of these, they are subject to change without notice as part of the company's product development process. The use of trademarks, product design and artwork is subject to licence or agreement. The design registrations, trademark registrations and copyrights are protected by law and the use or reproduction outside the terms of an agreement is prohibited.

The right to modify designs and dimensions is reserved. E & O.E.

V2.0125

**COALBROOK**

[www.coalbrookuk.co.uk](http://www.coalbrookuk.co.uk) | [info@coalbrookuk.co.uk](mailto:info@coalbrookuk.co.uk)